

470

Spirit of Adventure

T

Spirit of Adventure

Marsden Wharf

To Sept 83

Previous No 886 (or 398)

Telephone: 372-060
Telegrams: "SPIRAD"

P.O. Box 2276 ³⁹⁸
Auckland, 1

"Spirit of Adventure"



Operations Office: Marsden Wharf, Quay Street, Auckland, 1

Auckland Harbour Board
Box 1259
AUCKLAND 1

4 October/78

Attention : Chief Engineer



Dear Sir

We acknowledge receipt of your letter of 8th September in connection with 'Shore Power supply' for the "Spirit of Adventure" berth at Marsden Wharf, the Board has decided to delay the installation to a later date.

When a further decision is reached we shall write you again referring to your letter of 8th September.

Yours faithfully

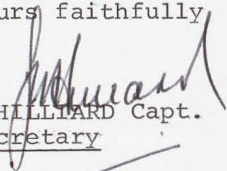
J HILLIARD Capt.
Secretary

Chief Engineer:

Noted

9/10/78

45
Electrical Engineer to note
the file

8 September 1978

Captain H.S. Hulford
Operation Director
"Spirit of Adventure"
P.O. Box 2276
AUCKLAND 1

Dear Sir

SHORE POWER SUPPLY "SPIRIT OF ADVENTURE"
MARSDEN WHARF

Your letter of 25 July 1978 addressed to the General Manager concerning the above matter has been referred to me for reply.

I would inform you that the installation of a standard 60 amp 400 volt power supply socket would cost approximately \$1,100, but it should be noted that the actual account rendered would be computed on a time and material basis.

The socket would be located at a point on the quay edge of Marsden Wharf close to the ship.

All energy used would be check metered by the Auckland Harbour Board, and an account rendered every quarter. The current rate is 7 cents per unit. However, this is subject to adjustment from time to time.

I trust the above information is of assistance and I now await your instructions as to whether you wish the work to proceed.

Yours faithfully

N. Seagar
CHIEF ENGINEER TO THE BOARD

OPF:JD

"398"

P.O. Box 2276
Auckland, 1

10/10/2

Mr SEAGAR

48
5' SEPT 1978

"Adventure"

SHORE POWER SUPPLY "SPIRIT OF
ADVENTURE" MARSDEN WHARF

ay Street, Auckland, 1

25 July/78



I attach herewith for
your signature a letter
to the Operations Director
concerning the cost of
supplying shore power
to the "Spirit of Adventure"
- alternatively you may
wish this letter to go
out under the G.M.'s
signature.

25 JUL 1978
JHS BFC

SHORE SUPPLY - MARSDEN
WHARF :

investigating the
shore supply for the
Marsden Wharf.

ing ASEA shore supply
s would involve a long
which would be most

The existing switch-
cupboard at Marsden is
now very cramped for
space, and whilst it would
be ideal to have the new
switchroom, we can at a
pinch install the extra
switchgear in the cupboard
in this case only. O.P. Frankh

t on the quay side close
ost for your providing
unt.

osition would be,
ly costs.

ciated.

to: Seagar

Report for O.P.

Please look at this urgently, with costs.

Is there any tie up with the new
Switchroom in Dec 6.

MD 27/7/78

R. E. J. Would you
please prepare
estimate
overat
O.P.F.

DGM Jones

Telephone: 372-060
Telegrams: "SPIRAD"

"398"
P.O. Box 2276
Auckland, 1

"Spirit of Adventure"

10/10/2

Operations Office: Marsden Wharf, Quay Street, Auckland, 1

The General Manager
Auckland Harbour Board
PO Box 1259
AUCKLAND

25 July/78

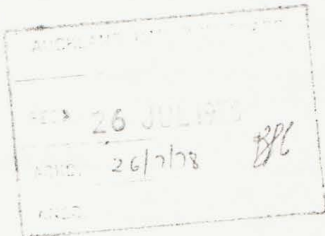

Dear Sir

Re : ELECTRICAL SHORE SUPPLY - MARSDEN WHARF :

The Trust is at this stage again investigating the feasibility of a 400v metered shore supply for the "Spirit of Adventure" berthed at Marsden Wharf.

We understand there is an existing ASEA shore supply outlet on the cargo shed but this would involve a long extension lead to reach the ship which would be most unsightly and inconvenient.

We would prefer to have the outlet on the quay side close to the ship but understand the cost for your providing this outlet would be to our account.

Could you let us know what the position would be, particularly in relation to likely costs.

Your co-operation would be appreciated.

Yours faithfully

H S HULEFORD Capt.
Operations Director

to: Huleford

Report for info.

Please look at this urgently, with costs.

Is there any tie up with the new Switchgear in Dec 6.

MS 27/7/78

R. E. J. Would you please prepare estimate re: report O.P.F.

DGM to see

Marsden Wharf.

14.8.78

Spirit of Adventure.

Estimated cost to install a Ships Supply socket on Quay edge for Spirit of Adventure.

Beehive and socket	\$ 212-00
Cable. 3 core 16mm ² PVC SWA PVC	\$ 40-00
Fixing Beehive + cable trench	\$100-00
Earth-leakage enclosure	\$120-00
Earth-leakage unit	\$ 37-50
Circuit breaker	\$ 98-00

Labour: 1 electrician + 1 apprentice
3 days @ \$4.00 hr/man + 25%

	\$ 270-00	
15% loading	\$ 40-00	
	\$ 310-00	\$ 310-00

10% contingency.

\$ 917-50
\$ 91-75

10% Admin.

\$ 1009-25
100-92

\$ 1110-17

Telephone: 372 640
Telex: "SPRAD"



Adventure

P.O. Box 2276
Auckland, 1

10/10/2

To: *Chief Engineer*

Date: *26/7/78*

Wharf, Quay Street, Auckland, 1

From:

PLEASE ACKNOWLEDGE

25 July/78

PLEASE REPLY DIRECT
SUBMITTING COPY TO
HEAD OFFICE



PLEASE REPORT

✓ to the EM Please

FOR YOUR INFORMATION
AND RETURN PLEASE

FOR NECESSARY ACTION
PLEASE

LOCAL SHORE SUPPLY - MARSDEN
WHARF :

will act as photocopy.
MS
27/7/78

again investigating the
red shore supply for the
red at Marsden Wharf.

JHQ 38

for
GENERAL MANAGER
SECRETARY
OPERATIONS MANAGER

existing ASEA shore supply
at this would involve a long
ship which would be most

We would prefer to have the outlet on the quay side close
to the ship but understand the cost for your providing
this outlet would be to our account.

Could you let us know what the position would be,
particularly in relation to likely costs.

Your co-operation would be appreciated.

Yours faithfully

H S HULEFORD Capt.
Operations Director

DEM trace
etc. 3 - to the General Manager please -



Telephone: 372-060
Telegrams: "SPIRAD"

"Spirit of Adventure"



Operations Office: Marsden Wharf, Quay Street, A

The General Manager
Auckland Harbour Board
PO Box 1259
AUCKLAND

AUCKLAND
REC'D 26 JUL 1978
ACK'D. 26/7/78
ANS'D

Dear Sir

ELECTRICAL SHOPS

Telephone: 372-060
Telegrams: "SPIRAD"

P.O. Box 2276
Auckland, 1

"Spirit of Adventure"



Operations Office: Marsden Wharf, Quay Street, Auckland, 1

10/10/2

The General Manager
Auckland Harbour Board
PO Box 1259
AUCKLAND

25 July/78



Dear Sir

Re : ELECTRICAL SHORE SUPPLY - MARSDEN WHARF :

The Trust is at this stage again investigating the feasibility of a 400v metered shore supply for the "Spirit of Adventure" berthed at Marsden Wharf.

We understand there is an existing ASEA shore supply outlet on the cargo shed but this would involve a long extension lead to reach the ship which would be most unsightly and inconvenient.

We would prefer to have the outlet on the quay side close to the ship but understand the cost for your providing this outlet would be to our account.

Could you let us know what the position would be, particularly in relation to likely costs.

Your co-operation would be appreciated.

Yours faithfully

H S HULEFORD Capt.
Operations Director

DGM to see
etc. 3 - to the General Manager please.

398

Auckland Harbour Board

3256 B

INSTRUCTIONS TO FOREMEN & INSPECTORS

ENGINEER'S OFFICE,

To THE FOREMAN OF WORKS

Date 3 May

19 77

Subject MARSDEN WHARF SHED 6
"SPIRIT OF ADVENTURE" ACCOMMODATION

CODE	NUMBER
2007	92/40-49

The floor outside the Office Lobby is virtually "floating" on water penetrating from below. The floor covering is lino, maybe over Plantmix and it is the Plantmix or whatever that is floating.

Please examine with a view to establishing the source of the water and put the matter right.

RS:JARP

CHIEF ENGINEER TO THE BOARD.

(This Form to be filled up & returned to Engineer's Office immediately on completion of Work)

This work was completed on _____ at a cost of:—

Labour	-	-	:
Material	-	-	:
Total \$	_____		:

3256 B

REMARKS: _____

Signature _____

Date _____ 19

Telephone: 372-060
Telegrams: "SPIRAD"

P.O. Box 2276
Auckland, 1

"Spirit of Adventure"



398

Operations Office: Marsden Wharf, Quay Street, Auckland, 1

The Supervisor
Maintenance Depart
Auckland Harbour Board
AUCKLAND

22 April 1977

Dear Sir

The floor between our offices in Shed 18 - Marsden Wharf requires repairing.

Two or three boards are rotten and in danger of collapsing through water damage.

It would be appreciated if this complaint could be investigated before an accident occurs.

Yours faithfully

H S HULFORD Capt.
Operations Director

Refer to CE's LHK
28/4



In Scott.
Please check out and have achieved
MS

Instr to ROW 2/5/77.
Please file RS. 2/5/77.

27 June 1975

THE CHIEF ENGINEER

THE SECRETARY

"SPIRIT OF ADVENTURE" NOMINATIONS FOR VOYAGE

There are probably up to 10 members of the staff of my Department who would be interested and would benefit from such a voyage.

If it accepted that the Board is to send staff members to the course would you please inform me of the criteria for the nominees and the method of selection and I will arrange to forward nominations from the Department.

CHIEF ENGINEER TO THE BOARD

RNC:JARP

E

23. 6. 1975

P.O. Box 2276
Auckland, 1

10/10/75

PLEASE ACKNOWLEDGE

PLEASE REPLY DIRECT
SUBMITTING COPY TO
HEAD OFFICE

PLEASE REPORT

FOR YOUR INFORMATION
AND RETURN PLEASE

FOR NECESSARY ACTION
PLEASE



"Adventure"

in Wharf, Quay Street, Auckland, 1

Please address replies to:
P.O. Box 2183,
AUCKLAND.

OKLAND HARBOUR BOARD
10 JUN 1975

Please advise if you have any nominations of staff in the age group stated likely to benefit from participation

"ADVENTURE"

P. D.
GENERAL MANAGER
SECRETARY
OPERATIONS MANAGER

"Adventure" Trust Board ran some special junior staff members from firms and Auckland. These voyages, although modest and very successful.

HO 38

It is intended to run further special voyages this year, the first of these will be between the dates of the 16th and 26th September 1975. The voyage will be similar to the standard "Spirit of Adventure" voyage run for secondary school children and will encompass the use of sailing dinghies, rudiments of seamanship and the marine sciences. The age limit intended is from 17 to 25 years and the reduced cost per nominee is \$150, tax deductible.

This is an opportunity to encourage youngsters in your Company to live harmoniously with others in close quarters, and to learn the value of unselfishness, tolerance and team spirit.

By means of these special voyages the Board hopes to make a useful contribution to industry and the Board further hopes that by supporting industrial voyages, industry in turn will demonstrate its approval of the idea behind the "Spirit of Adventure" programme.

Yours sincerely,

Peter D. Mulgrew
PETER D. MULGREW

Mr. Pemberton
Mr. Carr

} any nomination

Telephone: 372-060
Telegrams: "SPIRAD"

P.O. Box 2276
Auckland, 1

"Spirit of Adventure"

10/10/75

Operations Office: Marsden Wharf, Quay Street, Auckland, 1

19 June 1975

Please address replies to:
P.O. Box 2183,
AUCKLAND.

The General Manager,
Auckland Harbour Board,
P.O. Box 1259,
AUCKLAND.

AUCKLAND HARBOUR BOARD	
RECD.	20 JUN 1975
ACKD.	
ANSD.	

Dear Sir,

"SPIRIT OF ADVENTURE"

Last year the "Spirit of Adventure" Trust Board ran some special voyages for apprentices and junior staff members from firms and organisations in and around Auckland. These voyages, although expensive, were fully subscribed and very successful.

It is intended to run further special voyages this year, the first of these will be between the dates of the 16th and 26th September 1975. The voyage will be similar to the standard "Spirit of Adventure" voyage run for secondary school children and will encompass the use of sailing dinghies, rudiments of seamanship and the marine sciences. The age limit intended is from 17 to 25 years and the reduced cost per nominee is \$150, tax deductible.

This is an opportunity to encourage youngsters in your Company to live harmoniously with others in close quarters, and to learn the value of unselfishness, tolerance and team spirit.

By means of these special voyages the Board hopes to make a useful contribution to industry and the Board further hopes that by supporting industrial voyages, industry in turn will demonstrate its approval of the idea behind the "Spirit of Adventure" programme.

Yours sincerely,

Peter D. Mulgrew

PETER D. MULGREW

*Mr. Pemberton } any remainder
Mr. Carr.*

INSTRUCTIONS TO FOREMEN & INSPECTORS

ENGINEER'S OFFICE,

To FOREMAN OF WORKS

Date 14 June 1974 19

Subject "SPIRIT OF ADVENTURE" - MARSDEN WHARF

Approval has been given to proceed with work at the Spirit of Adventure Berth. This work consists of driving piles and providing a water supply.

The water supply is to be a 1" dia. METRIC meter, control valve, and 1" dia. hose connection. The meter and valve, etc, are to be housed in the kerb with a removable cover similar to the installation for the Waterfront Training Organisation. The hose connection is to be situated at approximately the 85 ft. mark Marsden west.

Lenders 2007/20/30-39
Water meter 2007/27/30-39

DW:GMW

[Signature]
CHIEF ENGINEER TO THE BOARD.

(This Form to be filled up & returned to Engineer's Office immediately on completion of Works)

This work was completed on _____ at a cost of:—

Labour	-	-	:
Material	-	-	:
Total \$	_____		:

REMARKS: _____

Signature _____

Date _____ 19

*Insts to you
DW*

W. H. H. 20/6/74

*page
to
be
22/6/74*

Auckland Harbour Board

10/10/74 ✓

MEMORANDUM

10 May 1974

FROM

THE HARBOURMASTER

TO

THE GENERAL MANAGER

13 MAY 1974

"SPIRIT OF ADVENTURE" - MARSDEN WHARF.

The Operations Director, "Spirit of Adventure" has requested that a water meter with 1" hose fitting and two spring piles be installed at the vessel's berth at Marsden Inner West.

At present the water supply is not metered and the existing large hose is wasteful.

Without some type of fendering a yacht lying alongside a solid wharf such as Marsden is likely to suffer damage.

Costs of the above items are estimated at :-

- ① Water meter \$170
 - ② Spring piles \$160
- 2/ Pieces with hog lines. D. Walker*

For the reasons given above I recommend that this work be carried out.

To N. Re. M. Re. 1. Re. 2. C/E 3. Had Downmaster 4/6/74

Authority is given to install piles at Board's cost. Agreement to be reached with the Trust as to payment for water meter before meter is installed.

G. Ross Blair
HARBOURMASTER

The General Manager.

① The cost of the water meter would be recovered in a relatively short time by the charging for usage at the Bay View rates.

② Your direction is sought as to what approach should be taken re. the piles, which if necessary could be purchased out of contingency funds.

*Agreement reached
 see letter this file
 from Spirit of Adventure
 14/5/74*

Insts to you.

DW

NOTE FOR FILE

865

"SPIRIT OF ADVENTURE"

Operations Manager met with Mr Lennox-King, 2.30 pm Friday 23 November and the following matters were discussed.

1. Security - Mr Lennox-King was informed that his present security arrangements are not satisfactory to the Board and the wirenetting fence along the northern boundary of the space allocated to the Trust and to the Waterside Workers' Drying Room must be taken to the top of the shed roof.
After some talk of unavailability of suitable wire and the failure of some donor to provide two rolls of wire, Mr Lennox-King said that he fully understood his responsibilities.
2. Parking - Mr Lennox-King was informed that the tenancy for office and storage space does not include parking and the situation whereby he parks his car in a cart dock space must cease. The Traffic Manager should now proceed with the marking of carpark spaces in the sealed cart dock space at the eastern side of the south wall and also a space adjacent to the southern door to the Trust's offices. This latter space should be offered to the Trust Board at the normal rental and other arrangements must be made for the Manager of the Mission to Seamen.
3. The Trust will not fit sliding windows into the office or erect illuminated signs at the south end of the shed as earlier stated by Mr L.J. Fisher. The repairs to the cladding of the shed underneath the office windows should now proceed and the painting of the shed exterior should be commenced as soon as possible. This matter has been discussed with both the Architect and Mr Seagar.
4. "Spirit of Adventure"- The vessel will be launched on Saturday 8 December and it is intended to step her mast at some city wharf on Tuesday 11 December. Mr Lennox-King will contact the Harbourmaster concerning a crane berth and the Queens Control Office with regard to the hire of a crane.

The vessel is expected to sail on 27 December for a ten day shakedown cruise.

The vessel will commence her first cruise on 22 January and thereafter sail on every second Tuesday, returning some 11 days later.

26 November 1973

R. Cooper
R. COOPER,
OPERATIONS MANAGER.

DISTRIBUTION:

Traffic Manager
Property Officer
Chief Engineer
Harbourmaster

For information & necessary action

RE

*Mr Pemberton } repairs to sheathy
Mr Scott ✓ } & exterior painting under way now
Pemberton, 30 Nov 73*

10/10/2

398



13 September 1973

Messrs Russell McVeagh McKenzie
Bartleet & Co
Barristers and Solicitors
P.O. Box 8
AUCKLAND, 1

Attention: Mr R.L. Macky

Dear Sir,

TENANCY "SPIRIT OF ADVENTURE"
SHED 6 MARSDEN WHARF

Further to my letter to you in this matter dated 16 August, I can now advise that further discussions have taken place regarding a Ships Electrical Supply at the Marsden Wharf Berth, and it is understood that such a supply will be required to the vessel from time to time.

As the supply plug is located on the western exterior wall of Shed 6 adjoining the tenancy area, it appears desirable that the conditions of supply be included in the Tenancy Agreement, and to this end the general arrangement is:

Ships Electrical Supply

A shore supply (3 phase 400 volts common user) is available from a plug located on Shed 6 West. Connection and disconnection is the responsibility of the Trust subject to advance arrangements being made through the Board's Electrical Section.

Costs for such supply (currently seven cents per unit) are the responsibility of the Trust.

Please include such a condition in the Agreement.

RLR:REW

The Chief Engineer
Copy for information.

Yours faithfully,

SECRETARY

SECRETARY

*copy sent to Mr. Bow
27/12/73 to note*

*Mr. Scott R.L.
"Franklin" to see please
CPZ*

10/10/2

16 August 1973

Messrs Russell McVeagh McKenzie
Bartleet & Co
Barristers and Solicitors
P.O. Box 8
AUCKLAND, 1

Attention: Mr R.L. Macky

Dear Sirs,

re: TENANCY "SPIRIT OF ADVENTURE"
SHED 6 - MARSDEN WHARF



The Board at its April meeting 1973 approved the allocation of 1,950 square feet of space located in the South West end of Shed 6 Marsden Wharf to the "Spirit of Adventure" Trust Board on a year to year tenancy.

The tenancy area is as shown edged red on the attached Site and Locality Plans P.4/3 and 4/4. The tenancy commenced on 1 July 1973 and is at a rental of 10 cents per annum if demanded.

The following conditions will apply -

- (a) The Board is responsible for all exterior maintenance (including painting) of Shed 6 in its present form. If the Trust wishes to install any special exterior joinery this will be at its own expense and requires the Chief Engineer's approval before any such installation is proceeded with.
- (b) The Trust is responsible for all interior alterations as may be required and will maintain the interior of the tenanted space throughout the tenancy to the satisfaction of the Chief Engineer. All alterations or additions require the written approval of the Chief Engineer before any work is proceeded with.
- (c) The Board is responsible for framing up the 65 foot long wall separating the tenancy area from the adjoining Drying Room. This wall will be lined both sides to a height of nine feet with Gibraltar Board. The Trust is responsible to frame in the area above this wall for its entire length to roof level and cover the frame with a wire mesh security barrier. The north end wall is to be filled in by the Trust with a wire mesh barrier on timber frame from floor to roof level.

... ..

Mr. Scott Is this in accordance with your understanding + with the notes being arranged by you?

[Signature] 20.8.73

correct. Please file R/L. 21/8/73.

A.H.B. Cargo Store

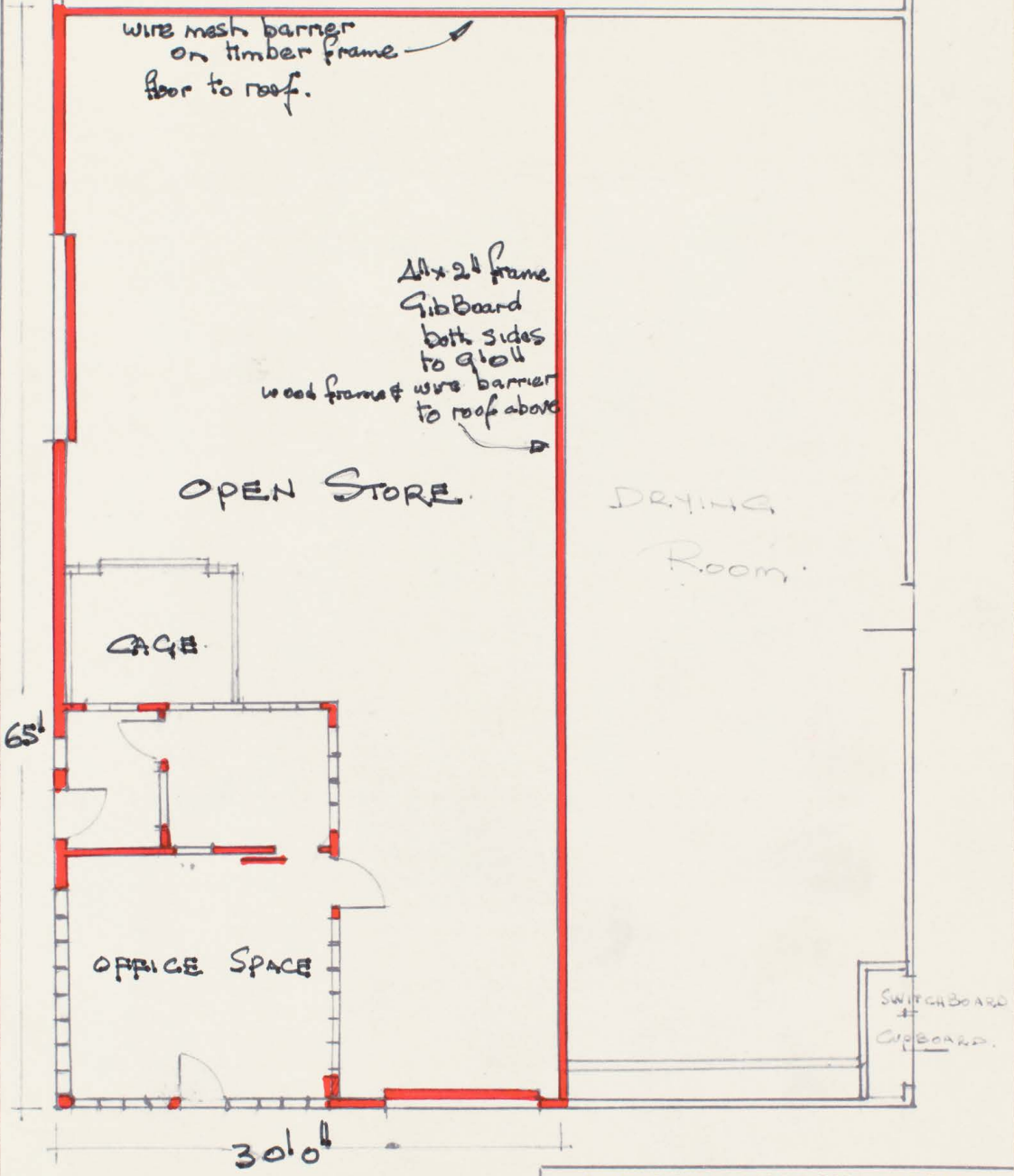

Scale 1/2" = 1 foot.
PART SHED 6

AUCKLAND HARBOUR BOARD	
ACCOMMODATION for "SPIRIT OF ADVENTURE" MARSDEN WHARF	
DRAWN W.V.B.	PLAN P4/4.
DATE 1:8:73.	

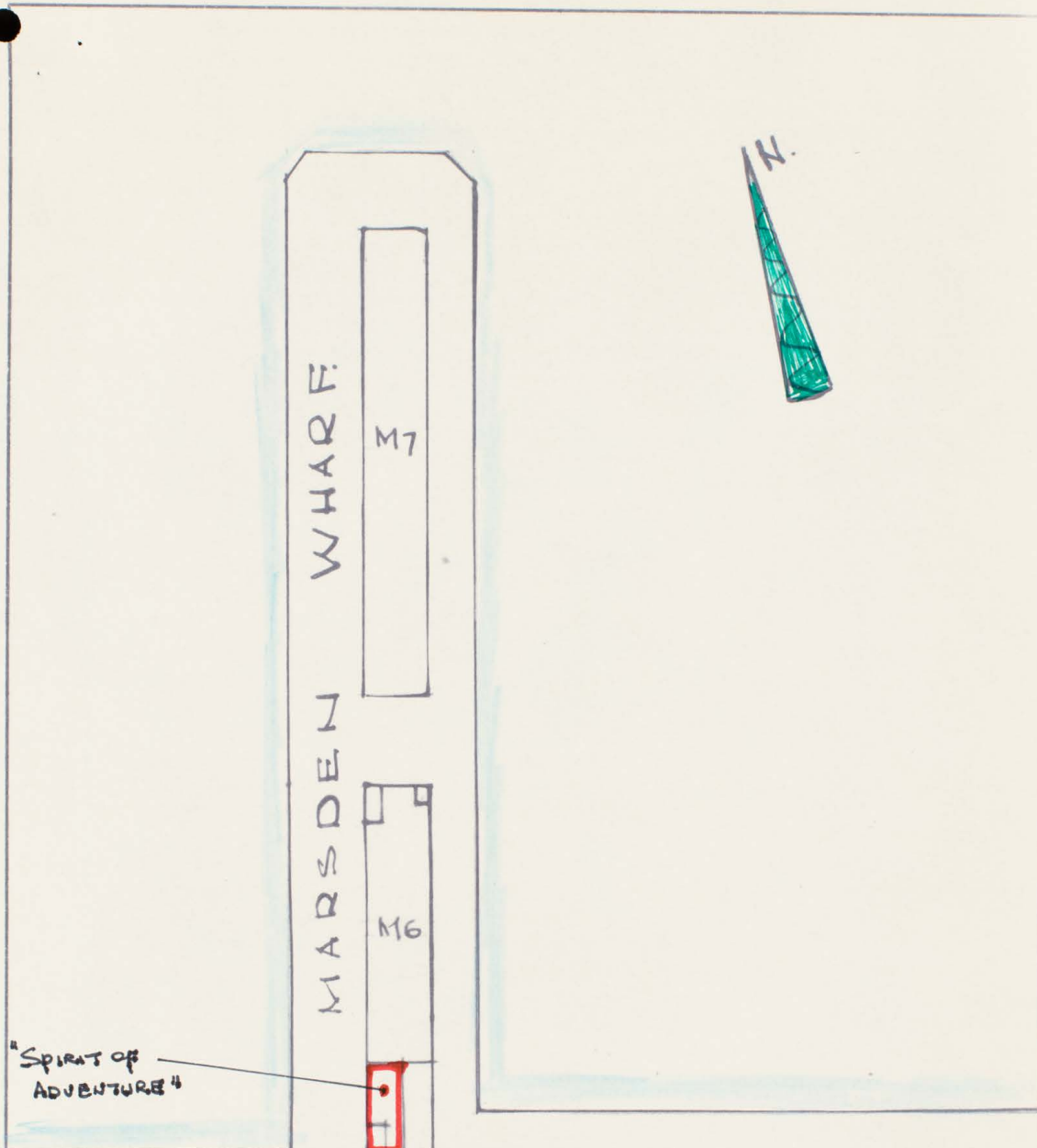

"SPIRIT OF ADVENTURE"

PORT.
BUILDING.

not to scale

AUCKLAND HARBOUR BOARD	
Tenancy SHED M6 MARSDEN WHARF	
DRAWN	W.K.B.
DATE	30.1.73
PLAN P4/3.	

File 398

16 July, 1973

THE CHIEF ENGINEER

THE SECRETARY

SHED 6 MARSDEN WHARF - ACCOMMODATION FOR
"SPIRIT OF ADVENTURE" TRUST

Under cover their letter of July 10 the Trust has submitted plans illustrating the proposed work as affecting the office accommodation.

The plans have been examined and are satisfactory.

In terms of General Manager's memo of 29.5.73 Mr. Lennox-King has been so informed and he is now arranging for the work to proceed.

CHIEF ENGINEER TO THE BOARD.

RAJS:JARP

Copy to: OPERATIONS MANAGER : For Information
MR.R.SCOTT : For Information

To: The Chief Engineer

16/7/73.

Marsden Wharf, shed 6
Accommodation for "Spirit of Adventure" Trust

The area to be occupied by the trust will incorporate the existing offices, large cage and approx 2000 sq ft of open storage area in the south-west corner of the shed.

Mr Lennox-King, operations director for the Trust will occupy the offices and wishes to carry out minor alterations in the office area. The Trust will carry out this work at their own expense & have a carpenter standing by ready to start on Thursday 19th July if we approve of the scheme for alterations.

The alterations include demolition of partitions, re-siting office doors, plus a new office door into the shed space. It is possible that some electrical alterations will be required also.

It is recommended that approval be given to the scheme so that the alterations can proceed

Encl: 1 copy scheme drawing of offices and
letter dated 10/7/73

~~A~~

T.73

File 398

- (d) The Trust is responsible for all water, gas and power charges separate metering costs and all maintenance and installation costs for such services.
- (e) No dangerous goods of any category to be stored.
- (f) The Trust is responsible for and will make good any damage to the premises during and on termination of the tenancy, caused by its servants or invitees.
- (g) The Trust is liable for any Insurance cover required over its furniture, fittings etc. within the premises.
- (h) No toilet facilities are being provided within the tenanted area.
- (i) No parking on the surrounding wharf area is provided for within the tenancy. Any parking requirements are to be made by special arrangement with the Traffic Manager.
- (j) The Trust will indemnify the Board against all claims and damages caused directly or indirectly through the granting of this tenancy.

Please complete a Tenancy Agreement to cover the above premises in the Board's standard agreement including the above terms.

The Operations Director for the Trust is Mr J. Lennox-King, C.P.O. Box 4071, Auckland, 1.

Yours faithfully,

The Operations Manager
Copy for information.

The Chief Engineer
Copy for information.

SECRETARY

SECRETARY

SECRETARY



10/10/2

"SPIRIT OF ADVENTURE" TRUST BOARD

C.P.O. BOX 4071 AUCKLAND NEW ZEALAND

RECEIVED
DATE: 11 JUL 1973
BY: D.
ANSW.

10 July 1973

The Secretary,
Auckland Harbour Board,
Box 1259,
AUCKLAND.

Dear Sir,

As requested in your letter of 4 May 1973 I enclose herewith two copies of drawings of the alterations the Trust Board proposes making to the office accommodation allocated to them in the Marsden Wharf shed.

I shall be pleased to have your early confirmation that the alterations are acceptable to the Harbour Board's officers.

Yours faithfully,

J. Lennox-King
Operations Director

AUCKLAND HARBOUR BOARD

TO

Chief Engineer

14/5/1973



"VENTURE" TRUST BOARD

AUCKLAND

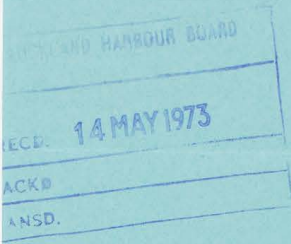

Please Acknowledge	
Please reply direct submitting copy to Head Office	
Please report	•
For your information and return please	
For necessary action please	✓

Berth

4 May.

assigned to your General Board.

g from your Chief Iteration work to

bour Board's support

Gen. Scott to see please

General Manager

chs
Secretary

Dem
C/E



"SPIRIT OF ADVENTURE" TRUST BOARD

C.P.O. BOX 4071 AUCKLAND NEW ZEALAND

9 May 1973

The Secretary
Auckland Harbour Board
P. O. Box 1259
AUCKLAND



Dear Sir:

re: "SPIRIT OF ADVENTURE" - Berth
and Storage Facilities

Thank you for your letter of 4 May.

A letter was sent by the undersigned to your General Manager on 2 May in this regard.

We now look forward to hearing from your Chief Engineer with regard to the alteration work to Shed 6.

We are delighted with the Harbour Board's support and most grateful for this.

Yours sincerely,

L. J. Fisher

Done ✓
C/R

EXTRACT FROM MINUTES
PROPERTY COMMITTEE
17 APR 1973

6. "SPIRIT OF ADVENTURE" BERTH AND SUPPORT FACILITIES

The Property Officer reported that the above vessel has been allocated a berth at inner west end of Marsden Wharf and a request has been received for authority to occupy some 2,000 sq. ft. at the south end of Shed 6 to provide storage facilities for the vessel's requirements. The Property Officer recommended that approval be given to the allocation of the necessary space subject to the conditions listed. The General Manager endorsed the recommendation.

Recommended -
That the reports be adopted.

Mr. Seagar } phase note
" Scott }

ADOPTED BY BOARD
26 APR 1973

12th April 1973

R.T. Lorimer,
GENERAL MANAGER.

Auckland Harbour Board

10/10/2

ITEM 8

12 April 1973

The General Manager
AUCKLAND HARBOUR BOARD

"SPIRIT OF ADVENTURE" BERTH AND SUPPORT FACILITIES

The Operations Manager has advised that this vessel has been allocated a berth at the inner west end of Marsden Wharf and that the Trust Board have requested the Board's Authority to occupy some 2,000 sq. ft at the south end of the adjacent Shed 6. The intention is to partition off this space to provide storage facilities for the vessel's requirements.

The temporary tenancy held by a Dry Cleaning Agent who services the Watersiders at the adjacent Port Building is affected.

It is recommended -

- (a) that approval be given to allocation of the necessary space
- (b) that a tenancy on a year to year basis be granted to the "Spirit of Adventure" Trust Board, at a nominal fee of 10c per annum, if demanded
- (c) that alteration work proposed by the Trust Board be required to be executed in a manner previously approved by the Chief Engineer.

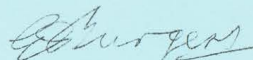

PROPERTY OFFICER

The Chairman,
Property Committee,
AUCKLAND HARBOUR BOARD.

I endorse the Property Officer's recommendation.

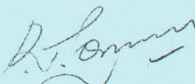

R.T. Lorimer,
GENERAL MANAGER.

12th April 1973

398



"SPIRIT OF ADVENTURE"

NOTES ON MEETING HELD AT MARSDEN WHARF 11.30 AM 10 APRIL 1973

PRESENT - Mr L.J. Fisher

Messrs Cooper and Scott (Architect)

The purpose of the meeting was to achieve some measure of agreement on the berth allocated and the shed space which could be made available for the "Spirit of Adventure" undertaking.

1. The inner western berth at Marsden Wharf, MA, is satisfactory in all respects to Mr Fisher. He does not envisage any insurmountable problems when handling the vessel in the Basin.
2. The general area of the south west corner of Shed M6, Marsden Wharf, is satisfactory for Mr Fisher's purposes.
3. Mr Fisher has made arrangement for sketch plans of the proposed alterations to this corner of the shed to be drawn up.
4. In brief, his proposals are shown on the attached sketch. The area to be used is different from his original ideas which totalled 1900 sq.ft. This area will incorporate one door in the Cart Deck at the south end of the shed.
5. Mr Fisher would like to paint the south end and part of the west wall of Shed M6 in navy blue and white, and also to erect some appropriate sign for the "Spirit of Adventure".
6. Mr Fisher would like to take up occupancy of the office space on or about the 1 May, and to have the rest of the area available in June or July of this year.
7. Mr Fisher gave the impression that he would be only too happy to co-operate with the Board and meet any requirements in the security of the shed, and these will be set out by Traffic Department.

R. Cooper
R. COOPER,
OPERATIONS MANAGER

DISTRIBUTION:

- General Manager
- Chief Engineer
- Architect
- Traffic Manager
- Harbourmaster

* 1/4: Wants 1950 sqft.

MS
17. 4.73 Phoned Scott - he is not to get involved in preparation of plans (other than site plan) without reference to me. *MS*

DE
DF
CF
PA

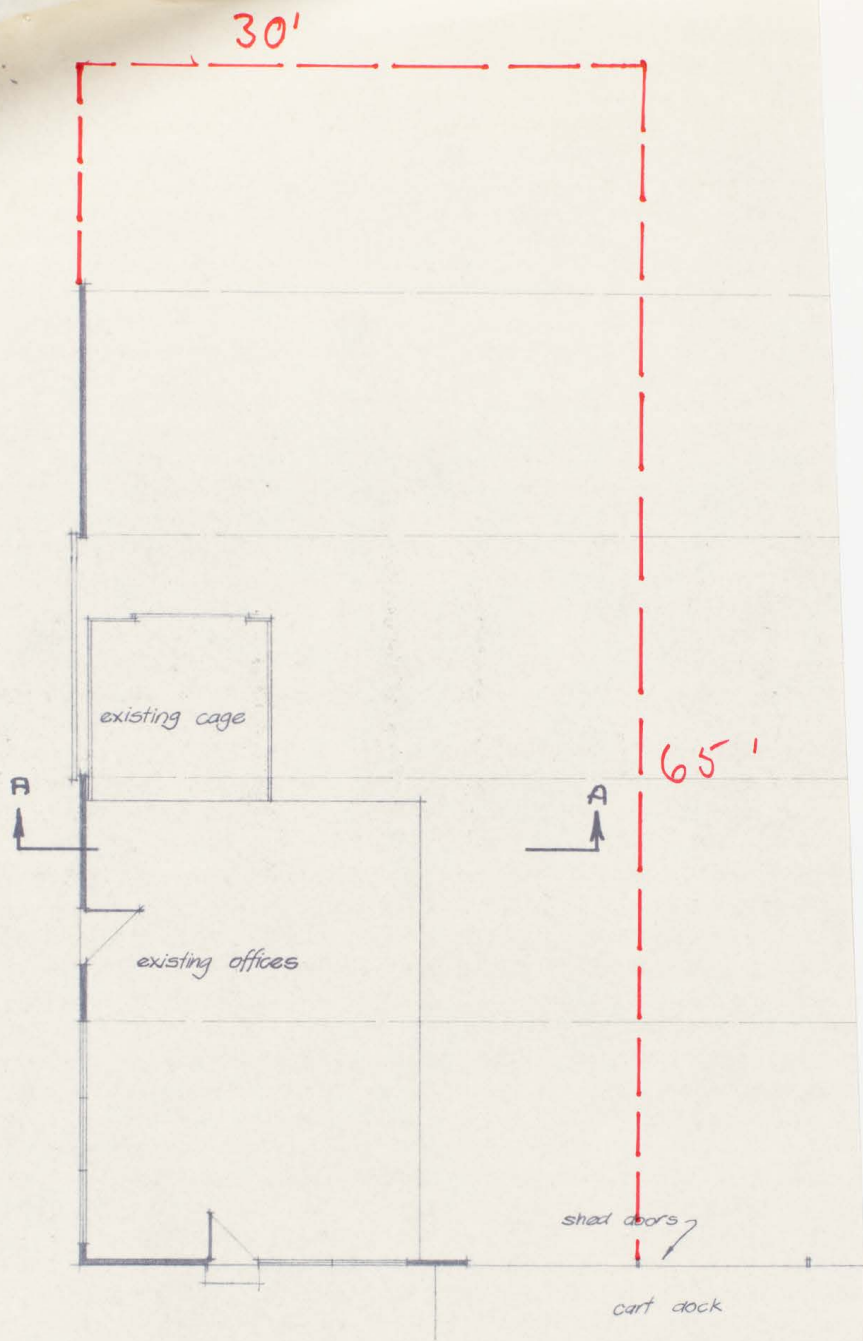

EXISTING PLAN

DESIGNED	R.S.
DRAWN	P. ASHTON.
CHECKED	

PASSED



AUCKLAND

MARSDEN WHARF

